



## LANDSCAPE RAKE ASSEMBLY

(HHGR & HHGR-60)

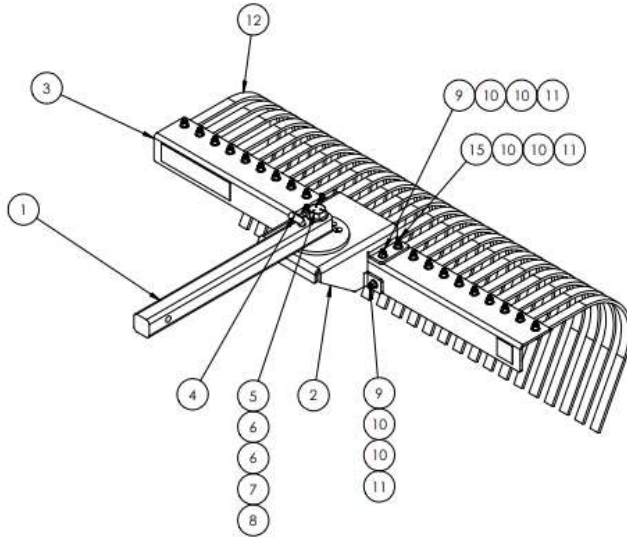

Image 1

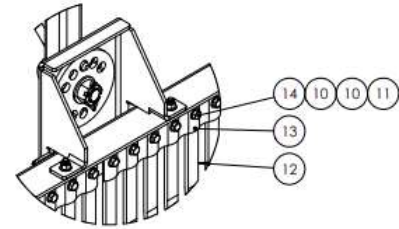

Image 2

### Heavy Hitch Ground Rake Parts List

ITEM NO.	PART NUMBER	DESCRIPTION	HHGR	HHGR-60
			QTY.	QTY.
1	301167	2" SOLID INSERT WELDMENT	1	1
2	301154	HHGR MOUNT WELDMENT	1	1
3	200076 (48") / 200210 (60")	RAKE ANGLE	1	1
4	400014	HITCH PIN	1	1
5	200211	1-BUNC X 4.5 HEX HD CAP SCREW GD5 (CUT)	1	1
6	400074	1 X .14 THICK WASHER	2	2
7	400090	1-BUNC CASTLE NUT	1	1
8	400091	3/16 x 2 COTTER PIN	1	1
9	400053	3/8-16UNC X 1.25 HEX HD BOLT	4	4
10	400056	3/8 X .03 WASHER	56	68
11	400057	3/8-16UNC NYLOCK NUT	28	34
12	400022	GROUND RAKE TINE	24	30
13	400021	GROUND RAKE TINE LOCK PLATE	4	5
14	400054	3/8-16UNC X 1.50 HEX HD BOLT	22	28
15	400089	3/8-16UNC X 2.00 HEX HD BOLT	2	2

Contact Service Department at Heavy Hitch for additional information

1-888-337-8999  
info@heavyhitch.com



**Instructions:**

Step 1) Install the 2" solid insert weldment (item #1) onto the HHGR Mount Weldment (item #2) using the 1-8UNC X 4.5" bolt (item #5) with one 1" washer (item #6) on the head side of bolt and one 1" washers (item #6) and one 1-8UNC castle nut (item #7) on the bottom side. Do not over tighten. Install one 3/16" cotter pin (item #8) to prevent castle nut from loosening.

Insert the hitch pin (item #4) into the desired spot to lock the insert weldment in place.

**\*\* STEP 1 IS COMPLETED AT FACTORY PRIOR TO SHIPPING \*\***

Step 2) Attach the rake angle (item #3) to step #1 with the 3/8-16UNC X 1.25 bolts (item #9) with one 3/8" washer (item #10) on both sides of the angle and one 3/8x16UNC nut (item #11) on the outside side of angle.

Step 3) Attach the rake tines (item #12) to the previous steps. Use the supplied 3/8-16UNC X 1.50 bolts (item #14) with two 3/8" washers (item #10) one on both sides and one 3/8-16UNC nut (item #11) per tine. Insert the ground rake tine lock plate (item #13) between the tine and washer/nut side holding every 6 tines in place. See image 2.

Step 4) Two locations will need the 3/8-16UNC X 2.00 bolts (item #15). See image 1.